

LOYALIST COLLEGE

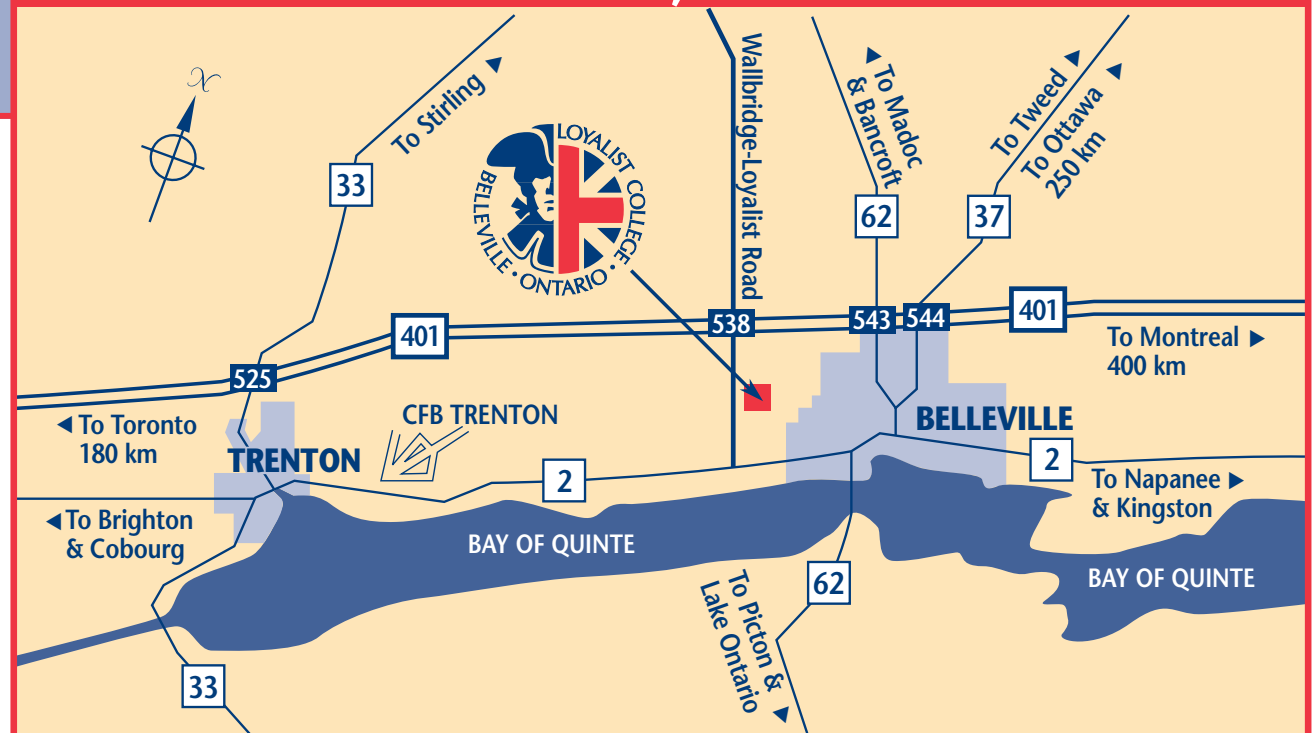

Loyalist College is located on Wallbridge-Loyalist Road (exit 538 off Highway 401) 180 kilometres east of Toronto, 400 kilometres west of Montreal, and just 1.6 kilometres from the Bay of Quinte. The Bay of Quinte is a 50-kilometre arm of Lake Ontario situated between Hastings and Prince Edward Counties. Loyalist also operates a campus for community programs in Bancroft.

BELLEVILLE, ONTARIO



Loyalist Grounds

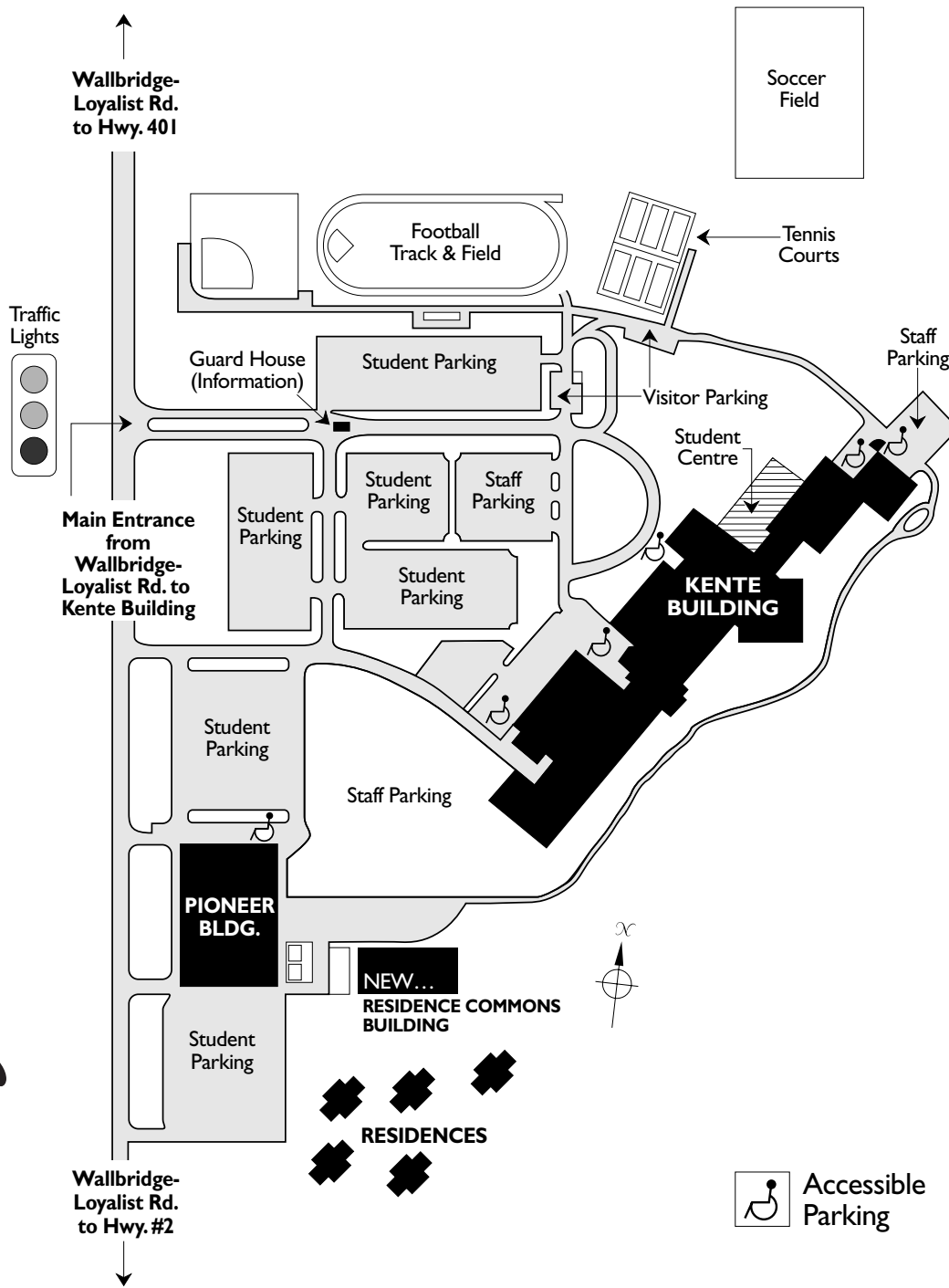

Aerial View of Loyalist College

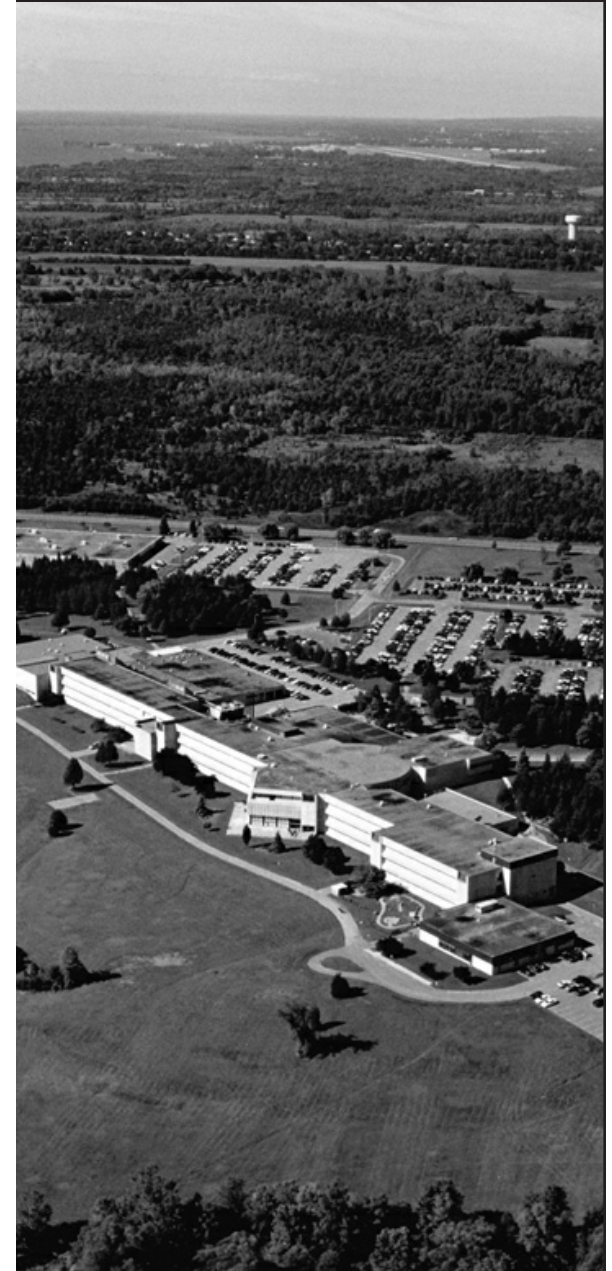

LOYALIST COLLEGE: KENTE BUILDING

LEGEND

1. Admissions Office
2. Cafeteria
3. Club 213
4. Bookstore
5. Alumni Hall
6. Student Centre
7. Health Centre
8. Student Services
9. Fitness Centre
10. E.C.E. Centre
11. S.O.A.R. Office
12. C.A.L. Central in the Anderson Resource Centre

ROOM NUMBERING

EXAMPLE: ROOM 3H4

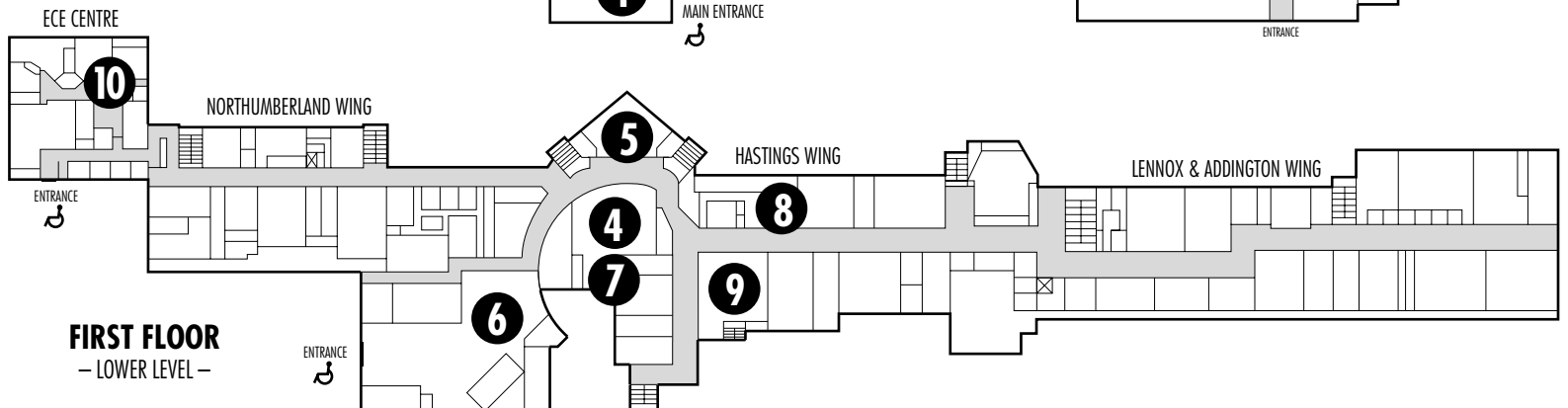
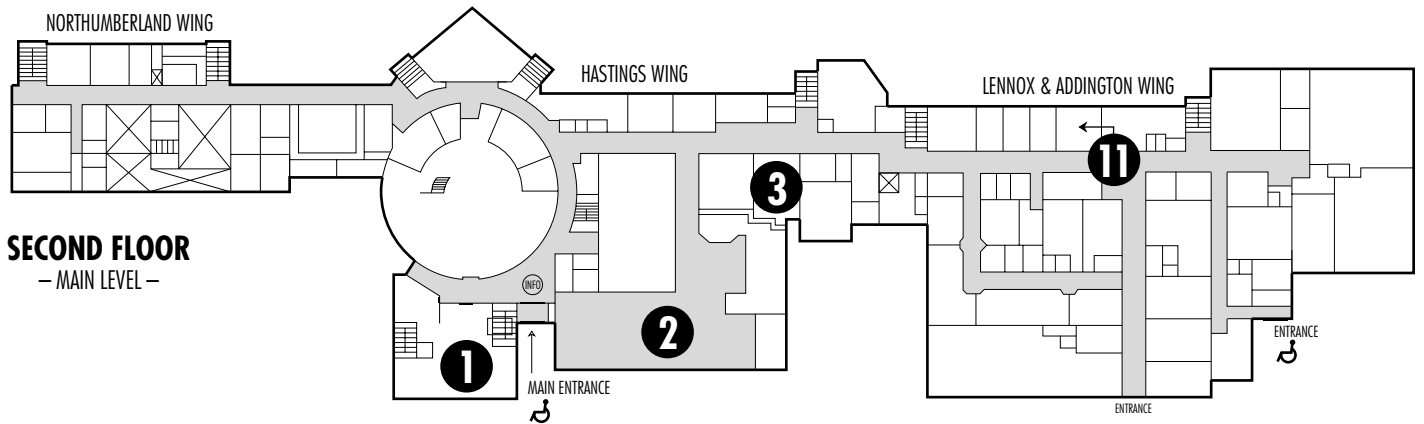
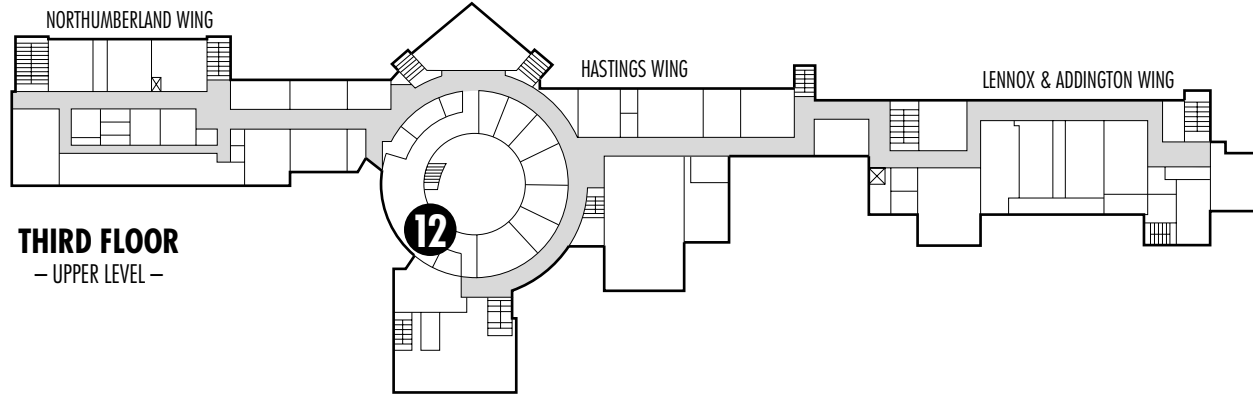

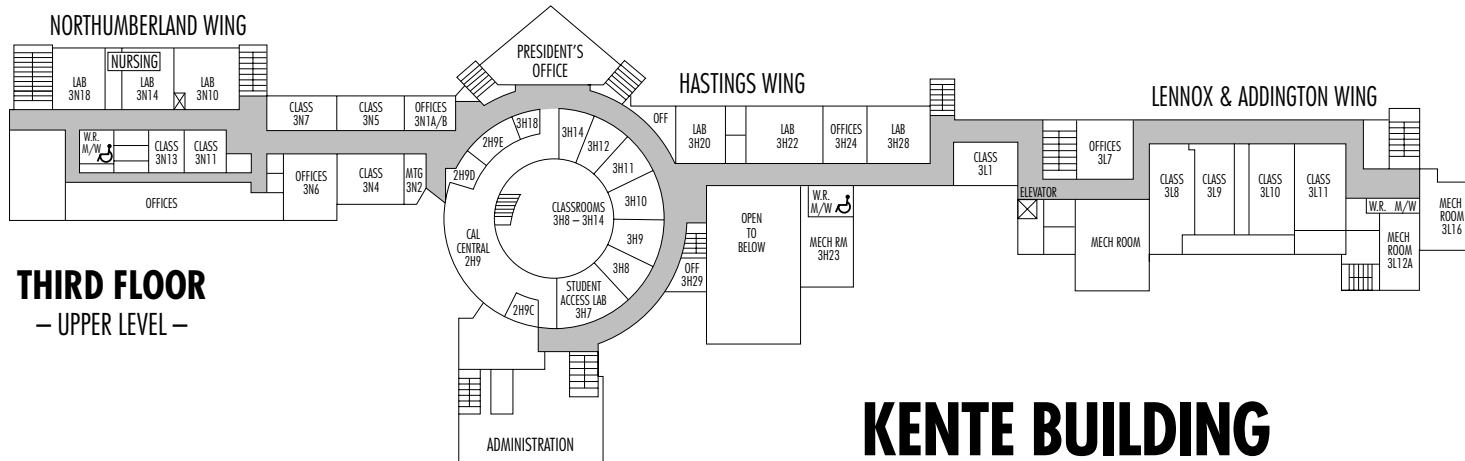

THIRD FLOOR
— UPPER LEVEL —

KENTE BUILDING

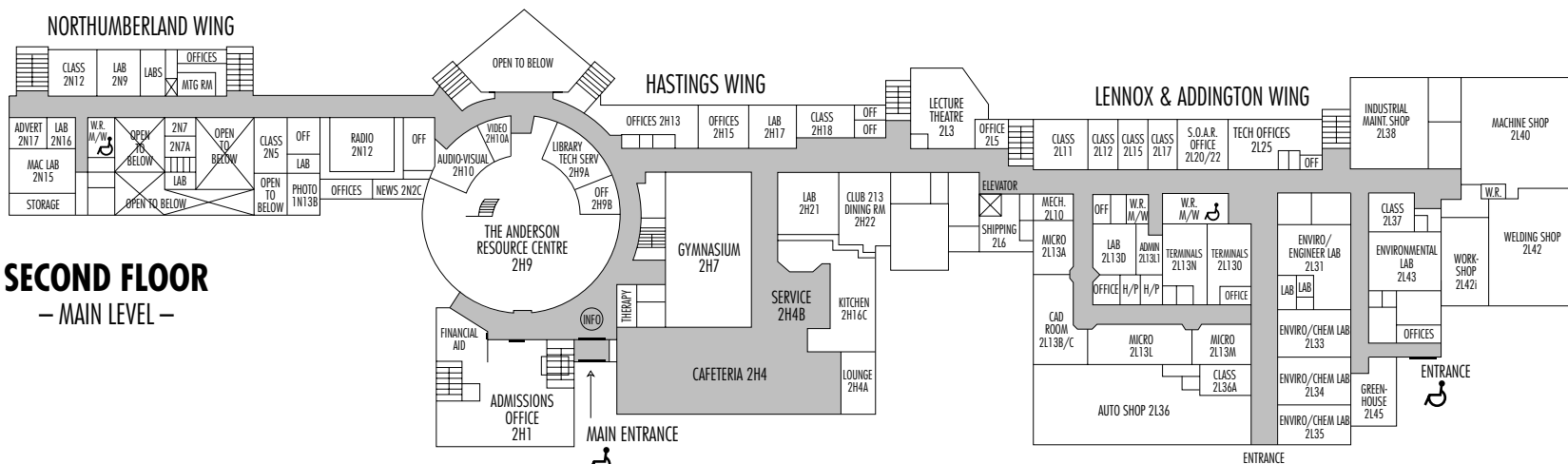

SECOND FLOOR
— MAIN LEVEL —

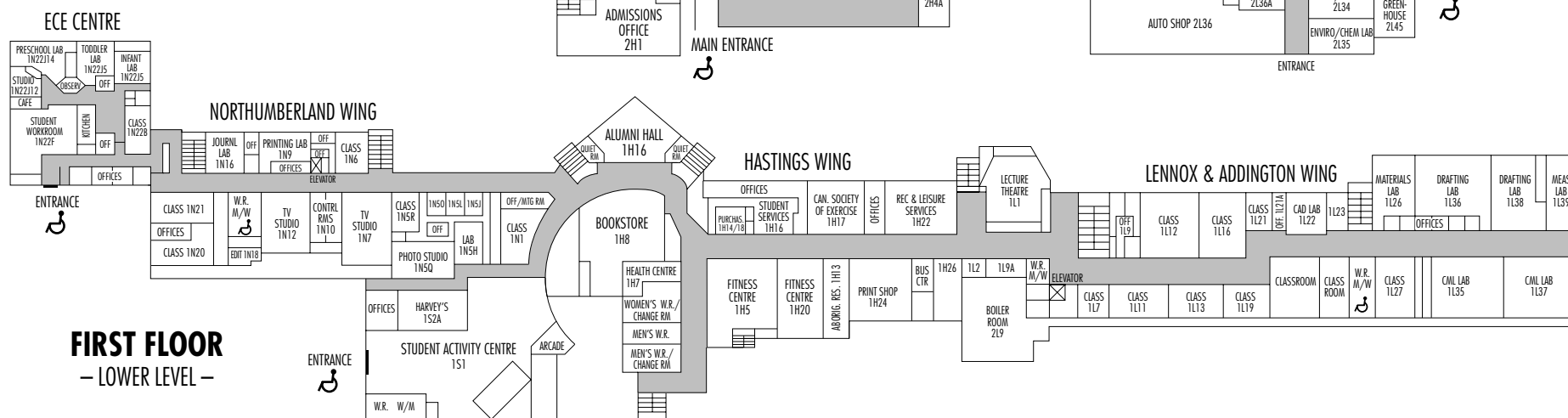

FIRST FLOOR
— LOWER LEVEL —